

RAZOR POWER LEG SYSTEM

Issue date: 2nd Feb, 2015

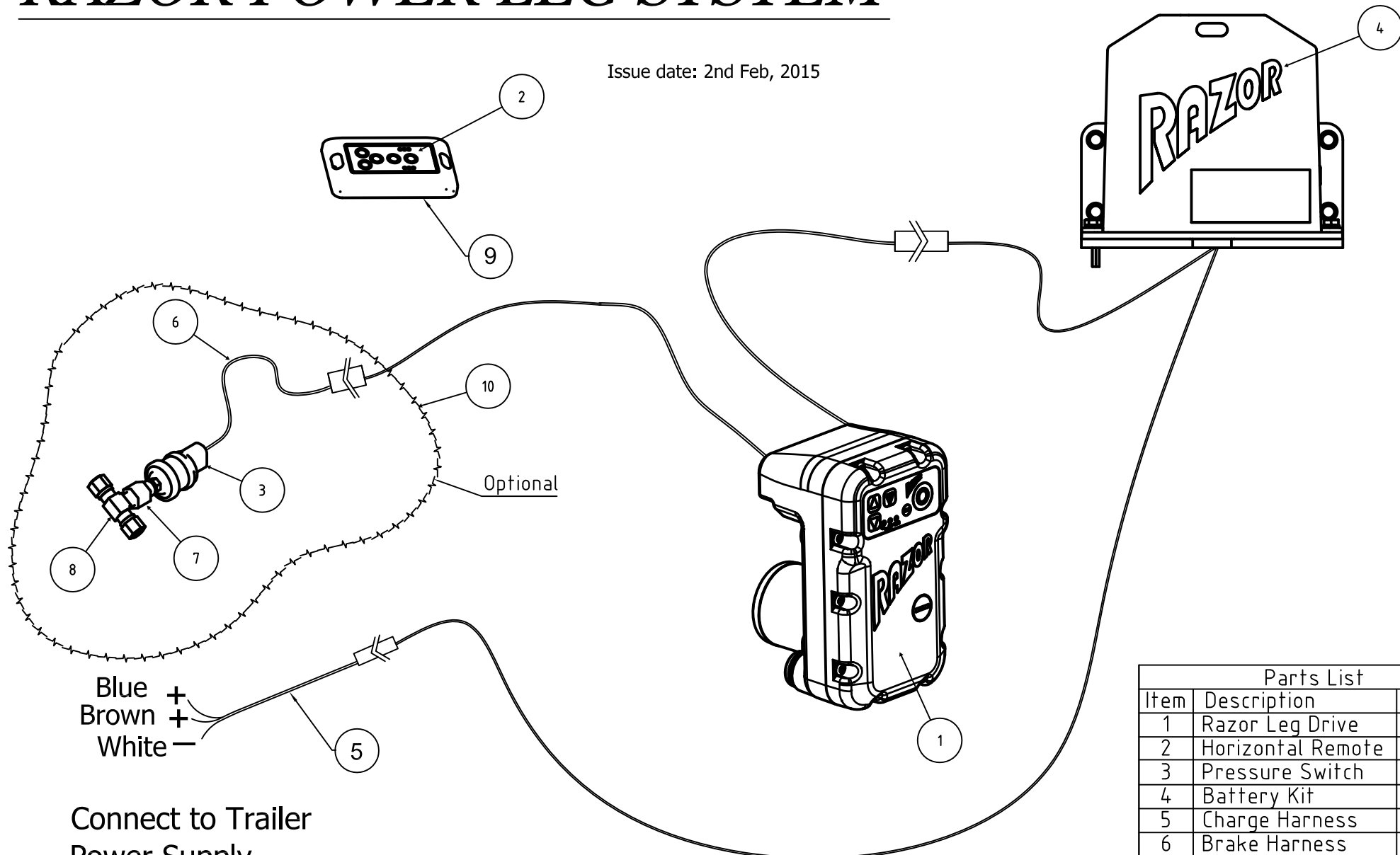

Blue +
Brown +
White -

Connect to Trailer
Power Supply
(Refer Note)

Note: Power is required (9 to 30VDC) to maintain Razor battery.
Connect matching wire colours between Razor and Trailer Harness.
i.e. Blue to Blue(auxillary), Brown to Brown(clearance) and White to White(negative)

| Parts List | | |
|------------|--------------------------------|----------|
| Item | Description | Part No. |
| 1 | Razor Leg Drive | LD14 |
| 2 | Horizontal Remote | RCHAP14 |
| 3 | Pressure Switch | PN0050A |
| 4 | Battery Kit | BKRA14 |
| 5 | Charge Harness | PN0005E |
| 6 | Brake Harness | PN0003D |
| 7 | Brake Line Socket | PN0051S |
| 8 | Brake Line Tee | PN0051B |
| 9 | Remote Bezel | RCAPBE |
| 10 | Brake Interlock Kit (optional) | 1300A |