

INSTALLATION INFORMATION

(FUWA KHITCH 37 MOUNT)

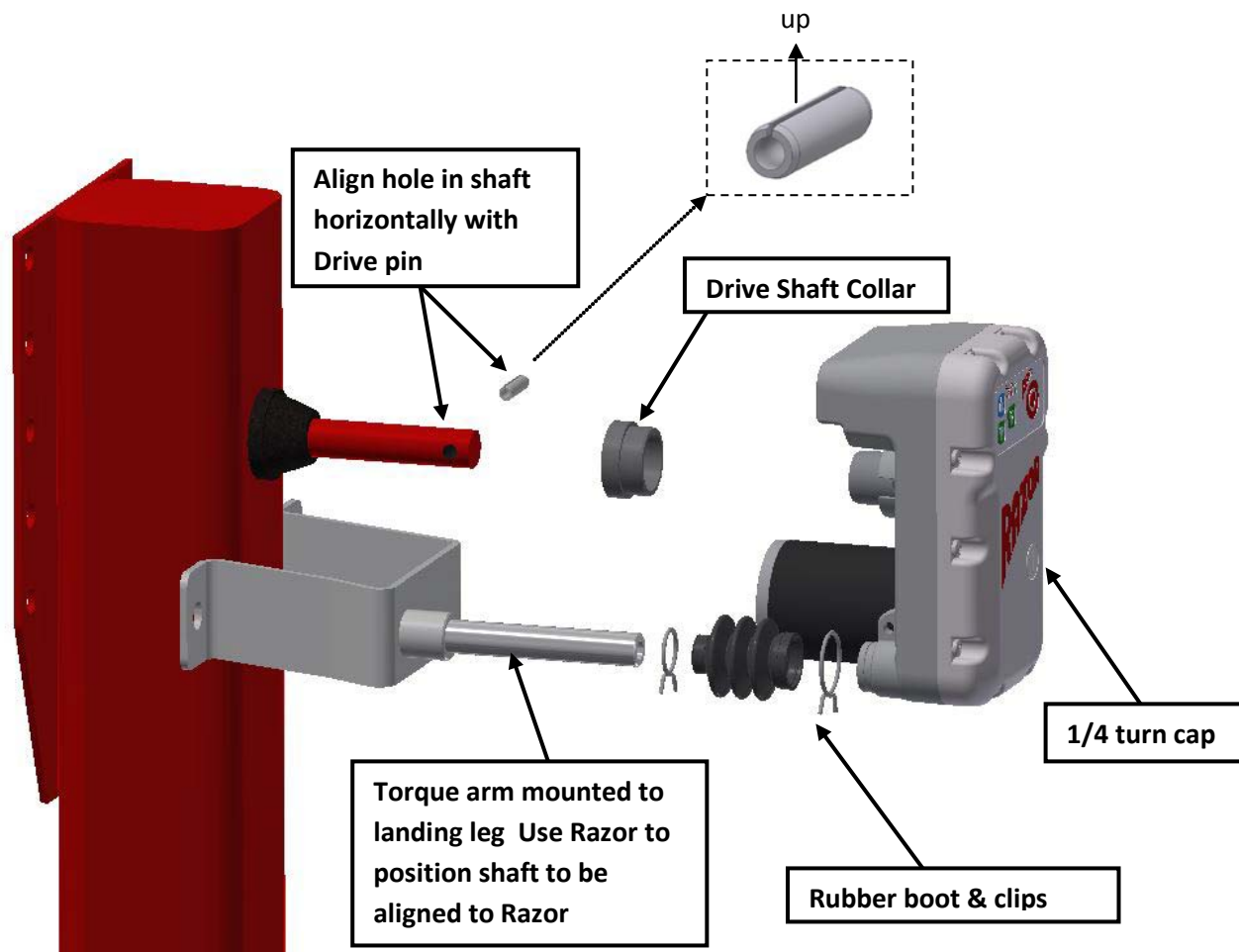

Important Notes:

Step 1. Use Razor drive to align the torque arm pin.

Step 2. Tighten torque arm bolts, ensuring Razor drive is free to slide along torque arm pin after tightening.

Step 3. Insert Drive pin (ensure the slot of drive pin facing up)

